

# VS629TM-WRC

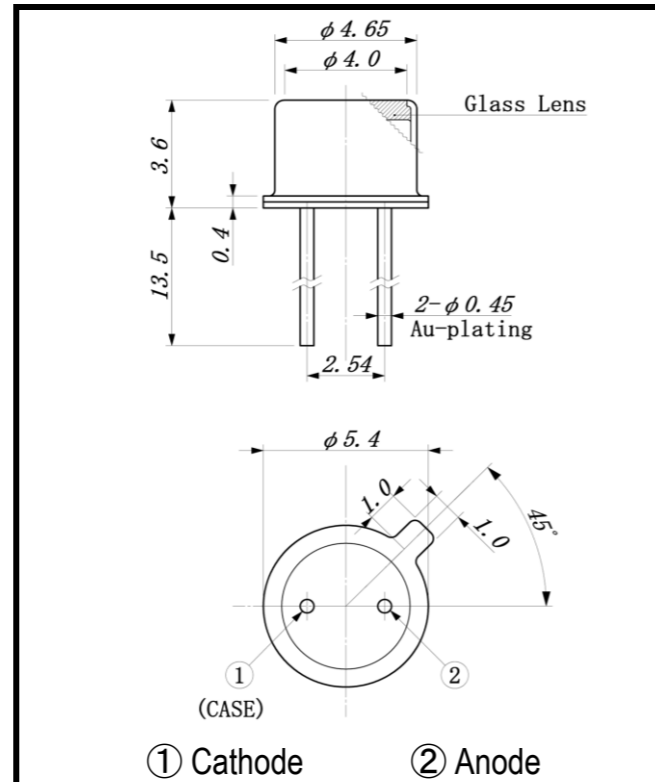
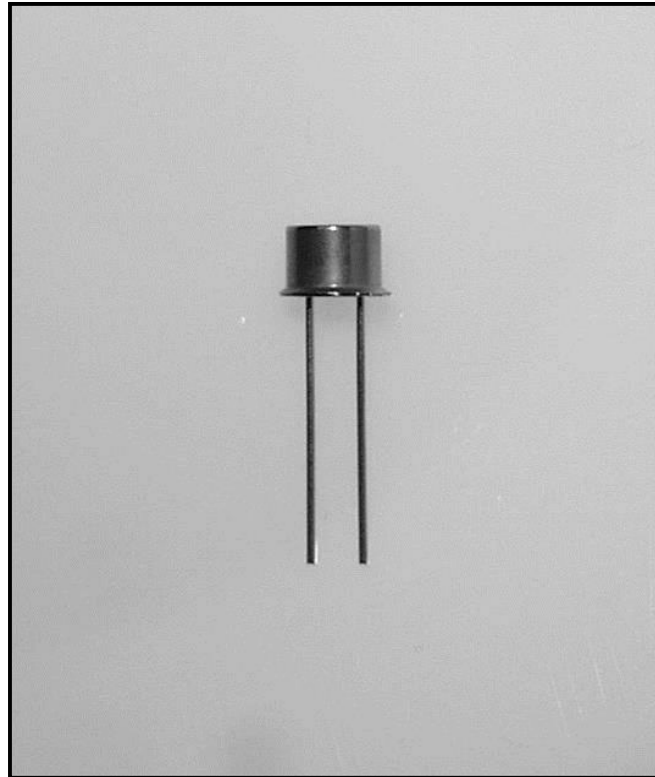

**FEATURES**

- Red Color Point-Source LED
- Emitting Window Dia.  $\phi 25 \mu m$

**APPLICATIONS** · Optical Switches

## 1. ABSOLUTE MAXIMUM RATINGS (Ta=25°C)

ITEM	SYMBOL	RATINGS	UNIT
Forward Current (DC)	IF	10	mA
Forward Current (Pulse)*1	IFP	30	mA
Reverse Voltage	VR	5	V
Power Dissipation	PD	30	mW
Operating Temp.	Topr	-20 TO 85	°C
Storage Temp.	Tstg	-30 TO 100	°C
Lead Soldering Temp.	Tls	260	°C

\*1:Tw=10uS,T=10mS

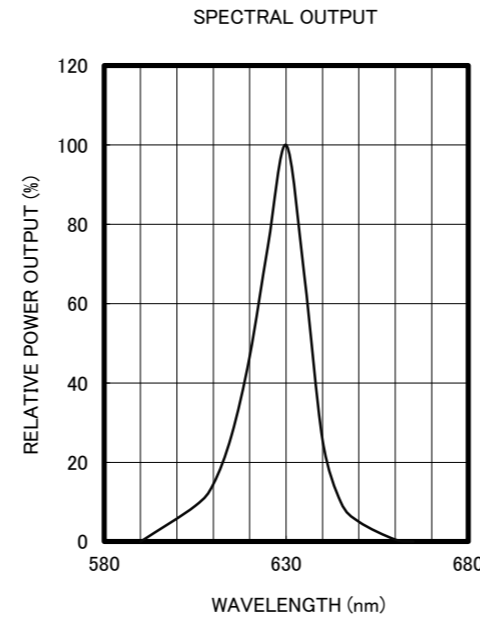

## 2. ELECTRICAL & OPTICAL CHARACTERISTICS (Ta=25°C)

ITEM	SYMBOL	CONDITIONS	MIN	TYP	MAX	UNIT
Power Output	PO	IF=5mA		30.0		$\mu W$
Forward Voltage	VF	IF=5mA		2.1	2.5	V
Reverse Current	IR	VR=5V			100	$\mu A$
Peak Wavelength	$\lambda p$	IF=5mA		630		nm
Spectral Line Half Width	$\Delta \lambda$	IF=5mA		15		nm
Half Intensity Beam Angle	$\theta$	IF=5mA		$\pm 45$		deg.

